

- |   |                       |    |                       |
|---|-----------------------|----|-----------------------|
| 1 | UNI EN 12165 - CW617N | 9  | MESCOLA EPP           |
| 2 | MESCOLA EPP           | 10 | UNI EN 12164 - CW614N |
| 3 | UNI EN 12164 - CW614N | 11 | UNI EN 12164 - CW614N |
| 4 | MESCOLA EPP           | 12 | MESCOLA EPP           |
| 5 | UNI EN 12164 - CW614N | 13 | UNI EN 12164 - CW614N |
| 6 | UNI EN 12164 - CW614N | 14 | UNI EN 12165 - CW617N |
| 7 | UNI EN 12164 - CW614N | 15 | FIBRA                 |
| 8 | UNI EN 12164 - CW614N | 16 | AES                   |
|   |                       | 17 | UNI EN 12165 - CW617N |

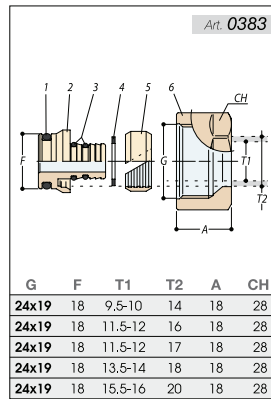

- 1 UNI EN 12164 - CW614N  
UNI EN 12165 - CW617N
- 2 P.T.F.E.
- 3 UNI EN 12164 - CW614N
- 4 MESCOLA EPP
- 5 MESCOLA EPP
- 6 UNI EN 12164 - CW614N

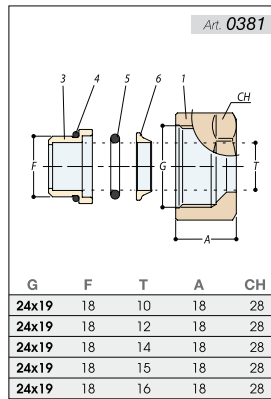
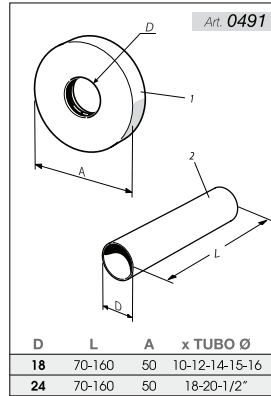
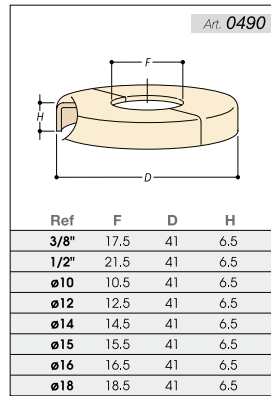

- 1 UNI EN 12164 - CW614N
- 2 UNI EN 12164 - CW507L

